

Order guide
 Please refer to the series code to select the type and parameters for ordering.

B Major category **KL** Category **G - G18** Series **F20** Inner width **R38** Bending radius **N10** Number of chain links **BKTG-G18** Joint

① Inside height ② Inner width ③ Bending radius ④ Number of chain links ⑤ Joint

Drag chain

Code	Type	Inside height ①	Cross-beam	Cable placement form	Number of Cavities	Material	Color	Allowable temperature	Flame retardant grade	Accessory
BKLG-G18	Mute	18	Bridge	Inner and outer diameter open	Single cavity	Engineering plastic	Black	-40°C~120°C	UL94-V2	Joint
BKLG-G28		28								
BKLG-G39		39								
BKLG-G48		48								
BKLG-G58		58								

- Features: Small pitch, extremely low noise operation (depending on running speed), wear and corrosion resistance, especially suitable for high speed and high acceleration environments.
- This series of drag chains includes a set of connectors (one for the mobile end and one for the fixed end).
- The series of drag chains do not include shims, which should be purchased separately.

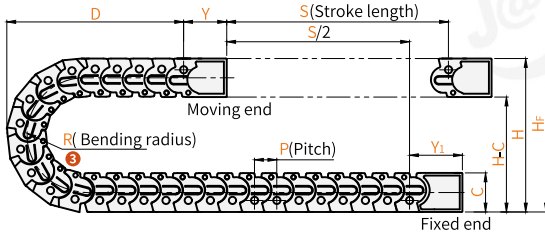

Inner and outer diameter open

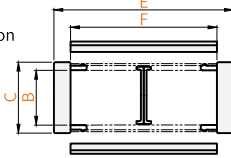

- H = Theoretical installation height
- Hf = Actual installation height
- D = Minimum distance when the drag chain is returned to the limit position
- $K = \pi \cdot R + \text{Safety amount}$

Straight overhead length vs. load graph FL_G

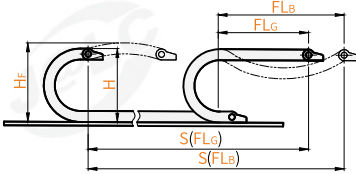

- Overhead length
- FL_c = Straight overhead length
- FL_b = Safety collapsed waist overhead length

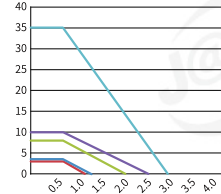
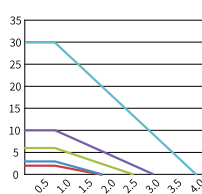

Straight overhead length FL_G Safety collapsed waist overhead length FL_B

Number of links per meter of chain = 1000 ÷ Pitch

Visual standards: first perspective

Model Code	Inner width F ②	Bending radius R ③	Number of links N ④	Joint ⑤	Pitch P	Max. cable diameter	Inner height B	Outer height C	Outer width E	Actual installation height Hf	Theoretical installation height				Y	Y ₁		
											H	D	K					
BKLG-G18	20	38		BKTG-G18	16	15	18	25.5	34.5	127	102	86	150	30	30			
	30								44.5									
	40								54.5									
	50								64.5									
	60								74.5									
BKLG-G28	30	55		BKTG-G28	24	25	28	38.8	46.5					54	30			
		75							189							149	120	220
		100							229							189	160	285
	50	55							189							149	120	220
		75							229							189	160	285
		100							279							239	210	360
	80	55							189							149	120	220
		75							229							189	160	285
		100							279							239	210	360
	120	55							189							149	120	220
		75							229							189	160	285
		100							279							239	210	360
BKLG-G39	50	75	1~						71									
		100							253							203	160	295
		125							303							253	210	375
	60	100							353							303	260	450
		125							403							353	310	530
		150							253							203	160	295
	70	100							303							253	210	375
		125							353							303	260	450
		150							403							353	310	530
	80	75							253							203	160	295
		100							303							253	210	375
		125							353							303	260	450
	90	75							403							353	310	530
		100							253							203	160	295
		125							303							253	210	375
150	100	353	303	260	450													
	125	403	353	310	530													
	150	403	353	310	530													

Model Code	Inner width F ²	Bending radius R ³	Number of links N ⁴	Joint ⁵	Pitch P	Max. cable diameter	Inner height B	Outer height C	Outer width E	Actual installation height	Theoretical installation height			Y	Y1	
											H	D	K			
BKLG-G48	50	100								332	267	210	385			
		125								382	317	260	465			
		150									432	367	310	530		
		200									532	467	410	700		
	75	100									332	267	210	385		
		125									382	317	260	465		
		150									432	367	310	530		
		200									532	467	410	700		
	100	100			BKTG-G48	35	42	48	66.8		332	267	210	385		
		125									382	317	260	465		
		150									432	367	310	530	68	59
		200									532	467	410	700		
125	100									332	267	210	385			
	125									382	317	260	465			
	150									432	367	310	530			
	200									532	467	410	700			
150	100									332	267	210	385			
	125									382	317	260	465			
	150		1~							432	367	310	530			
	200									532	467	410	700			
BKLG-G58	100	115								367	307	240	440			
		150								437	377	310	550			
		200									537	477	410	710		
		250									637	577	510	865		
	125	115									367	307	240	440		
		150									437	377	310	550		
		200									537	477	410	710		
		250				BKTG-G58	40	50	58	76.8	637	577	510	865	105	105
	150	115									367	307	240	440		
		150									437	377	310	550		
		200									537	477	410	710		
		250									637	577	510	865		
175	115									367	307	240	440			
	150									437	377	310	550			
	200									537	477	410	710			
	250									637	577	510	865			

- When choosing the installation height, you should refer to the actual installation height HF value in the table.
- For the overhead length, please refer to the overhead length and load relationship chart, and call when over-length or over-load.
- If it is the first time to use, there is a possibility that the drag chain length is not enough, it is recommended to choose 1 or 2 more sections for backup, and then disassemble and adjust when installing.
- Please refer to the product introduction of the drag chain or visit the e-commerce platform to use the selection tool to calculate the theoretical length of the drag chain.

B
 KF
 G - G28

Major category
 Category
 1 Inside height

Order guide

Please refer to the series code to select the type and parameters for ordering.

Shim

Code	Type	Inner height ¹	Material	Color	Allowable temperature	Flame retardant grade	Applicable drag chain code
BKFG-G28	Mute	28	Engineering plastic	Black	-40°C~125°C	UL94-V2	BKLG-G28
BKFG-G39		39					BKLG-G39
BKFG-G48		48					BKLG-G48
BKFG-G58		58					BKLG-G58

Please select the appropriate number of shims according to the inner width F of the Drag Chain and the size of the shims.

BKFG-G28

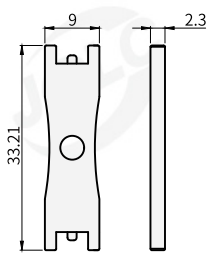

BKFG-G39

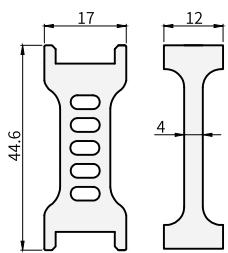

BKFG-G48

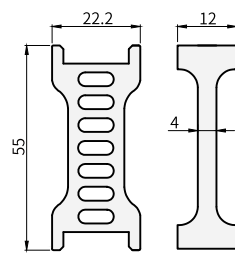

BKFG-G58

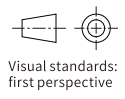
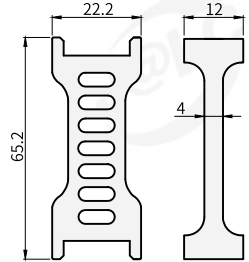

B Major category
 KT Category
 G - G18 Series
 F20 Inner width
 ① Inside height ② Inner width

Order guide
 Please refer to the series code to select the type and parameters for ordering.

Joint

Code	Type	Inner height ①	Material	Color	Allowable temperature	Flame retardant grade
BKTG-G18	Mute	18	Engineering plastic	Black	-40°C~120°C	UL94-V2
BKTG-G28		28				
BKTG-G39		39				
BKTG-G48		48				
BKTG-G58		58				

This series of drag chains do not include shims, which should be purchased separately.

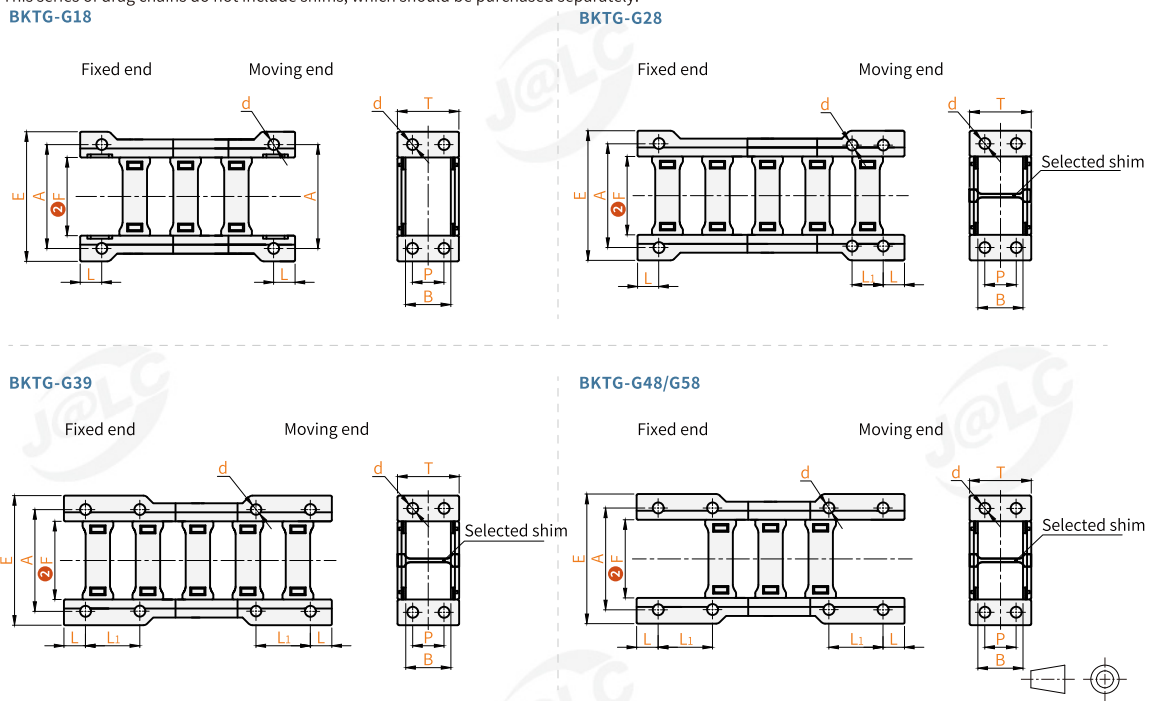

Model		A	E	L	Li	B	T	P	d	Applicable drag chain
Code	Inner width ② F									
BKTG-G18	20	30.5	40.5							
	30	40.5	50.5							
	40	50.5	60.5	10	—	18	25.5	12	4.2	BKLG-G18
	50	60.5	70.5							
	60	70.5	80.5							
BKTG-G28	30	44.5	54.5							
	50	64.5	74.5	11	12.5	28	38.8	16	5.4	BKLG-G28
	80	94.5	104.5							
BKTG-G39	120	134.5	144.5							
	50	65	77							
	60	75	87							
	70	85	97	12.5	22.5	39	53	22	7.2	BKLG-G39
BKTG-G48	80	95	107							
	90	105	117							
	50	67	81							
	75	92	106							
BKTG-G48	100	117	131	10	20	48	66.8	30	6.5	BKLG-G48
	125	142	156							
	150	167	181							
	100	123	139							
BKTG-G58	125	148	164	20	35	58	76.8	45	8.7	BKLG-G58
	150	173	189							
	175	198	214							

Visual standards: first perspective