

B Major category |
 KL Series |
 J - F20 Category |
 R28 2 Bending radius |
 N10 3 Number of chain links |
 BKTJ 4 Joint

Order guide: Please refer to the series code to select the type and parameters for ordering.

B Major category |
 KT Series |
 J - F20 Category |
 1 Inner width

Order guide: Please refer to the series code to select the type and parameters for ordering.

Drag chain

Code	Type	Inside height	Cross-beam	Cable placement form	Number of Cavities	Material	Color	Allowable temperature	Flame retardant grade	Accessory
BKLJ	General use	15	Bridge	Non-openable	Single cavity	Engineering plastic	Black	-20°C~80°C	UL94-V0	Joint

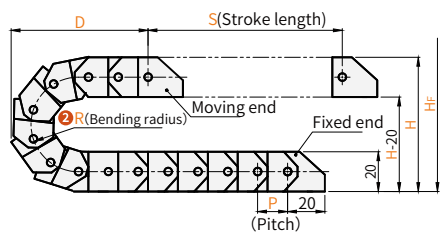

- H = Theoretical installation height
- H_f = Actual installation height
- D = Minimum distance when the drag chain is returned to the limit position
- K = π · R + Safety amount

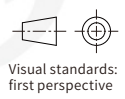
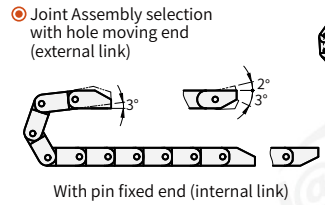
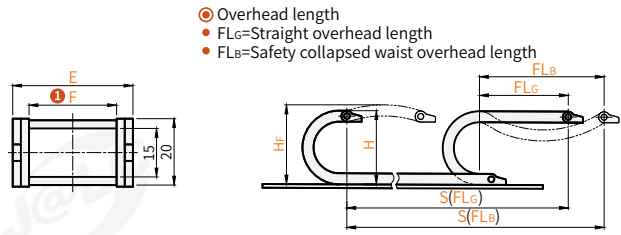
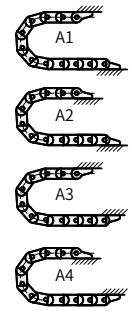

50 links per meter of chain.

Code	Model		Bending radius R	Number of links N	Joint	Installation size			Actual installation height H _f	Outer width E	Pitch P	Max. cable diameter	Max. overhead load (kg/m)	Max. overhead length(m)
	Inner width F					H	D	K						
BKLJ	20		28	1~	BKTJ	76	60	130	96	28.2	20	12	0.3	0.8
	30		28			96	70	160	116					

Joint

Code	Type	Inside height	Material	Color	Allowable temperature	Flame retardant grade
BKTJ	General use	15	Engineering plastic	Black	-20°C~80°C	UL94-V0

Suitable for inner width F20

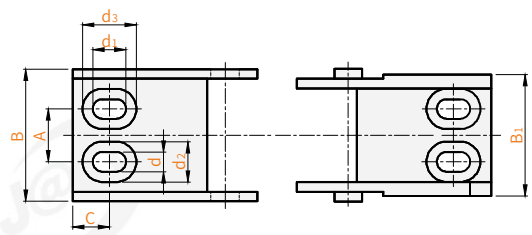

Suitable for inner width F30

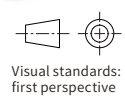
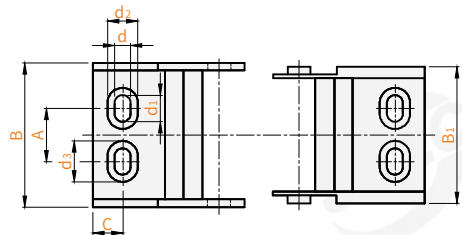

Code	Model		A	B	B ₁	C	d	d ₁	d ₂	d ₃
	Inner width F									
BKTJ	20		11.3	28.5	28.5	7.8	4.2	7	8.2	11
	30		14	38.5	38.5					