

**B** (Major category) **KL M - F18** (Series) **R28** (Bending radius) **N10** (Number of chain links) **BKTM** (Joint)

Order guide  
Please refer to the series code to select the type and parameters for ordering.

**B** (Major category) **KT M - F18** (Series) **F18** (Inner width)

Order guide  
Please refer to the series code to select the type and parameters for ordering.

○ Drag chain

Code	Type	Inside height	Crossbeam	Cable placement form	Number of cavities	Material	Color	Allowable temperature	Flame retardant grade	Accessories
<b>BKLM</b>	General use	18	Semi-closed	Inner diameter open	Single cavity	Engineering plastic	Black	-20°C~80°C	UL94-V0	Joint

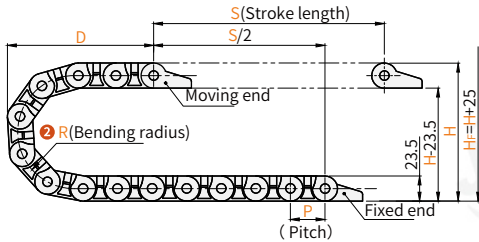

- H=Theoretical installation height
- H<sub>r</sub>=Actual installation height
- D=Minimum distance when the drag chain is returned to the limit position
- K=π·R+Safety amount

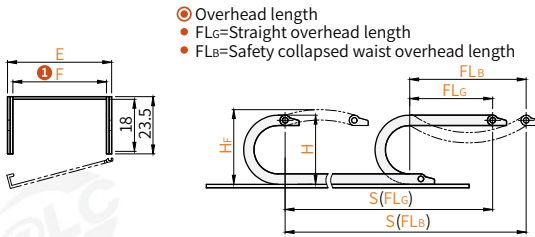

- Joint assembly selection:  
With hole moving end (external link)

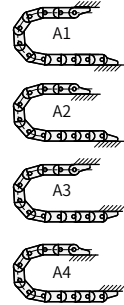
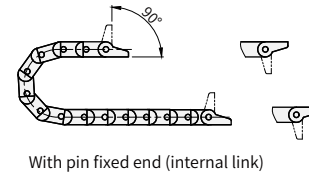

Visual standards:  
first perspective

○ 30 links per meter of chain.

Model Code	Inner width F ①	Bending radius R ②	Number of links N ③	Joint ④	Installation size			Actual installation height HF	Outer width E	Pitch P	Max. cable diameter	Max. overhead load (kg/m)	Max. overhead length (m)
					H	D	K						
<b>BKLM</b>	18	28	10	BKTM	80	70	150	105	28	33.5	16	0.5	1.2
		38			100	80	185	125					
		48			120	90	215	145					
	25	28	10	BKTM	80	70	150	105	35	33.5	16	0.5	1.2
		38			100	80	185	125					
		48			120	90	215	145					
	37	28	10	BKTM	80	74	168	105	47	33.5	16	0.5	1.2
		38			100	80	185	125					
		48			120	90	215	145					
50	28	10	BKTM	80	70	150	105	60	33.5	16	0.5	1.2	
	38			100	80	185	125						
	48			120	90	215	145						
		75			175	120	300	200					

○ Joint

Code	Type	Inner height	Comb plate	Material	Color	Allowable temperature	Flame retardant grade
<b>BKTM</b>	General use	18	No	Engineering plastic	Black	-20°C~80°C	UL94-V0

Suitable for inner widths F18

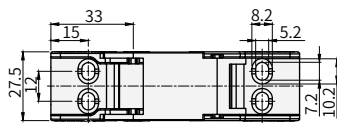

Suitable for inner widths F25

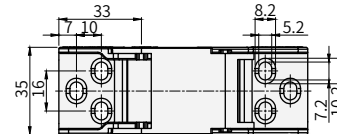

Suitable for inner widths F37

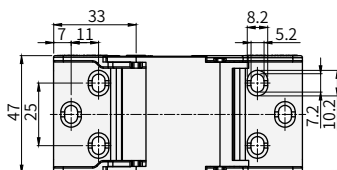

Suitable for inner widths F50

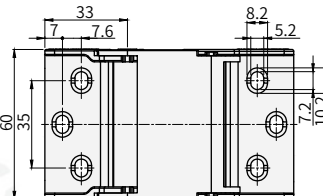

Model Code	Inner width F ①
<b>BKTM</b>	18
	25
	37
	50

Visual standards:  
first perspective