

JKK40 - **1** - **C** - **100** - **A1** - **F0** - **C** - **S0**
 Code 2 Accuracy class 4 Slider type 6 Cover
 Order guide 1 Lead 3 Track length 5 Motor connection flange 7 External photoelectric switch
 Please refer to the series code to select the type and parameters for ordering.

Code	Transmission	Foundation	Operating environment	Slide type	Base width
JKK40	Screw transmission	Steel	General environment	Standard	Base width 40mm

○ Covered

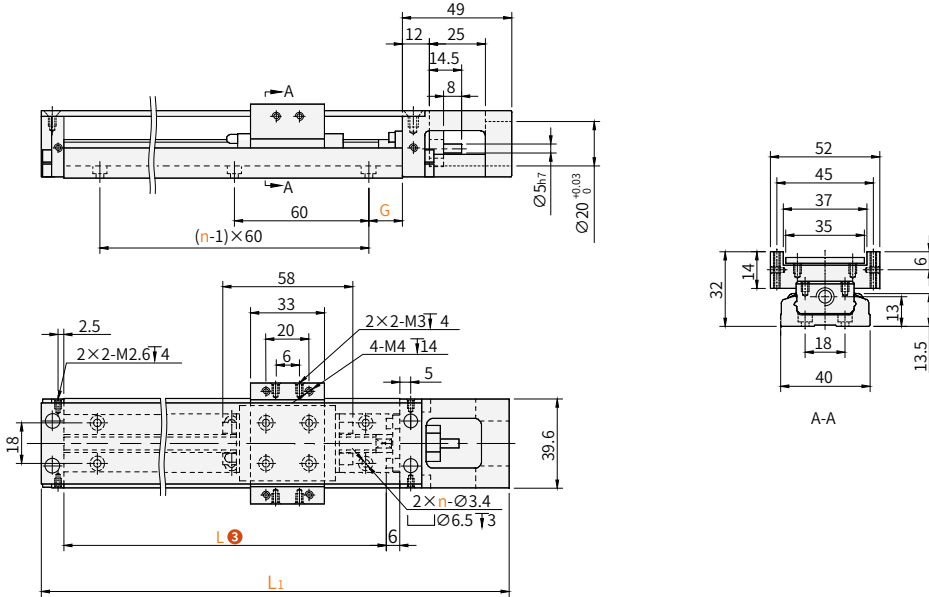
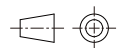
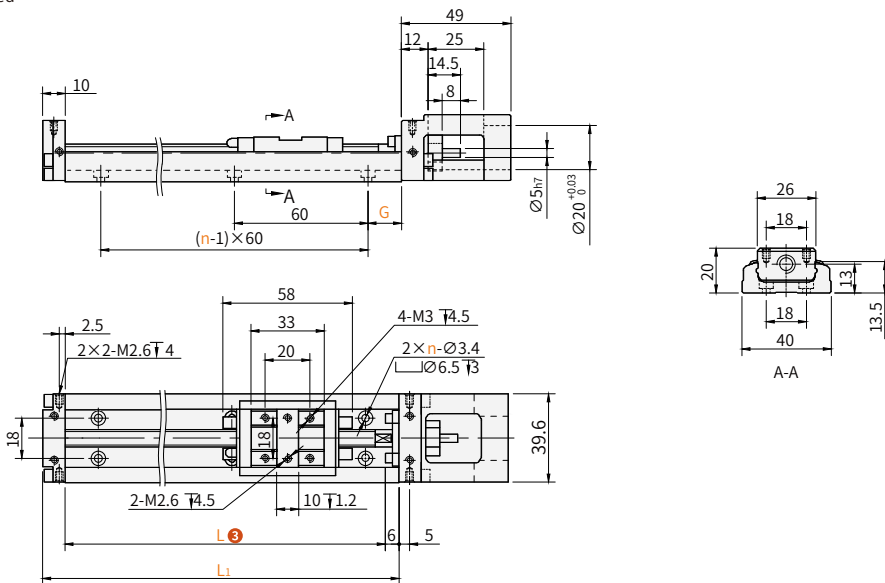

○ Unprotected



Visual standards: first perspective

Model		Accuracy class 2	Track length L 3	Slider type 4	Motor connection flange 5	Cover 6	External photoelectric switch 7	Table length L ₁	G	N	Maximum stroke					
Code	Lead 1										Single slide without cover	Single slide with cover	Double slide without cover	Double slide with cover		
JKK40	1	C (General grade) F (Precision grade)	100 ※	A1 (Single slide) A2 (Double slide)	F0 F1 F3 F4	Not indicated: (none) With cover: C; C	Not indicated: (none) S0 Limit rail only. S2 Extreme rail + SX674	159	20	2	36	—	0.48	0.55	—	—
			150								86	34	0.6	0.68	0.67	0.76
			200								139	84	0.72	0.82	0.72	0.89

- The numbered track lengths are not available for double slides.
- Please contact us if you need OMRON brand or PNP type for photoelectric switch.

Motor connection support and motor correspondence table

Motor connection
Support: F0

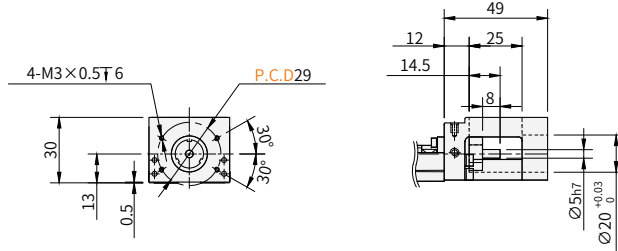

Motor connection

Support: F1

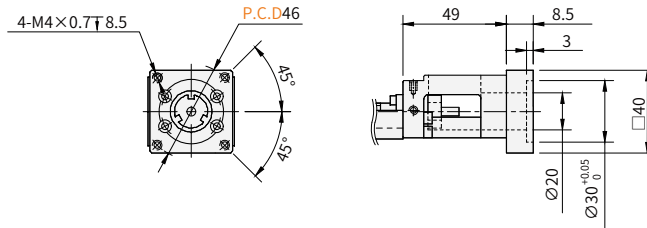

Motor connection

Support: F2

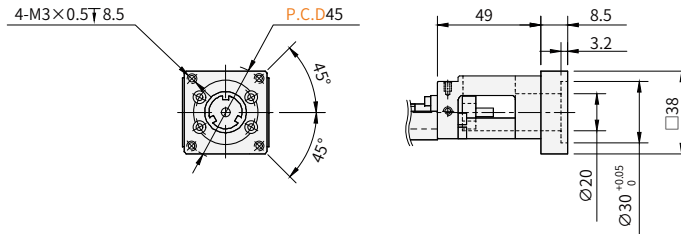

Motor connection

Support: F3

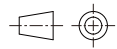
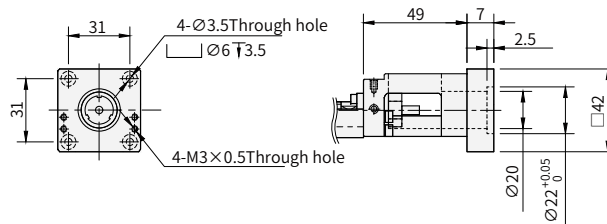

Visual standards: first perspective

Code	Applicable motor type	Motor connection flange	Applicable brands		Output power
			Manufacturer's name	Specification	
JKK40	Servo motor	F0	—	—	—
		F1	Mitsubishi Motors	MSM01	50W
		F2		HC-PQ13	100W
	Stepper motor	F1	Panasonic Corporation	HC-KFS053	50W
		F2		HC-KFS13	100W
		F3	Leadshine	MSM5AZ	50W
				MSM01	100W
				42	—

○ Limit switch/Mounting rail size chart
S0 (limit rail)

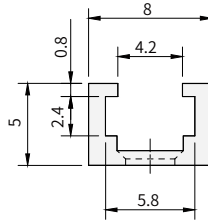

S2 (limit rail + Omron S × 674)
Covered

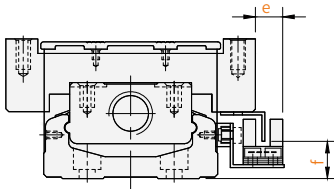

Unprotected

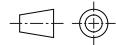
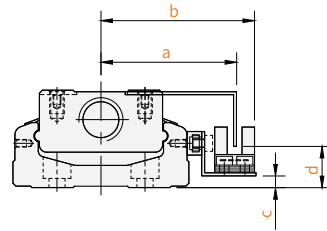

Visual standards: first perspective

Code	External photoelectric switch	a	b	c	d	e	f
JKK40	S2Extreme rail + SX674)	36.5	44.3	1	9.8	10.5	12

○ Accuracy class

Code	Track length L	Positional reproducibility		Position accuracy		Stroke parallelism		Maximum starting torque (N-cm) (N-cm)	
		General grade	Precision grade	General grade	Precision grade	General grade	Precision grade	General grade	Precision grade
JKK40	100	±0.01	±0.005	—	0.020	—	0.010	0.8	1.2
	150								
	200								

○ Allowable static moment

Code	Accuracy class	Allowable static moment					
		Linear guides					
		Pitch MP(N-m)		Partial pendulum MY (N-m)		Rolling MR(N-m)	
		Single slide	Double slide	Single slide	Double slide	Single slide	Double slide
JKK40	General grade	33	182	33	182	81	162
	precision grade						

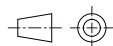
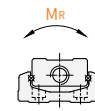
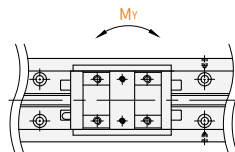
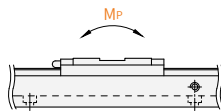

Visual standards: first perspective

○ Allowable load

Code	Accuracy class	Basic load rating (N)			
		Ball screw		Linear guides	
		C (dynamic)	C (dynamic)	C (dynamic)	C (dynamic)
JKK40	General grade	676	1284	3920	6468
	precision grade	735	1538		