

C **FD L** - **A1** - **A15** - **R1.1**
 Major category (C) Series (FD L) Nominal diameter (A1) Material (A15) Belt radius (R1.1)
 Order guide: Please refer to the series code to select the type and parameters for ordering.

Code	Shape	Material ①	Surface treatment	Accessory
CFDL-A1	Double U groove	A5052	Natural color anodizing	Retaining ring (SUS304)
CFDL-S1	groove	SUS304	—	

① The bearings are of the press-in type.

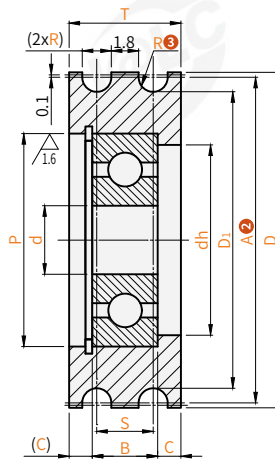

Remaining 6.3

Bearing precision:
 GB/T 307.1 Grade 0
 Equivalent:
 JIS B 1514 Grade 0

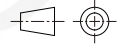

Visual standards: first perspective

Model		R③	S	d	P	dh	D	D1	T	B	C	Applicable bearing	Applicable round belt diameter	
Code	A②													
CFDL-A1 CFDL-S1	15			3	10	8.1	16.9	13	9	4		BCTC-M1-P-623ZZ		
	20	1.1	4	4	13	11.1	21.9	18	10	5	2.5	BCTC-M1-P-624ZZ	2	
	30			6	19	16.1	31.9	28		6		BCTC-M1-P-626ZZ		
	20			4	13	11.1	21.9	17	11	5	3	BCTC-M1-P-624ZZ		
	30	1.6	5	6	19	16.1	31.9	27		6	2.5	BCTC-M1-P-626ZZ	3	
	40			10	26	23.1	41.9	37	14	8	3	BCTH-M1-P-6000ZZ		
	45						46.9	42						
	23			15	13.1	24.9	19			5	4	BCTC-M1-P-696ZZ		
	28			6	19	16.1	29.9	24	13	6	3.5	BCTC-M1-P-626ZZ		
	30	2.1	6				31.9	26						4
	40						41.9	36						
	45			10	26	23.1	46.9	41	14	8	3	BCTH-M1-P-6000ZZ		
	48						49.9	44						
	28			8	19	16.1	29.9	23	15	6	4.5	BCTC-M1-P-698ZZ		
	40	2.6	7	10	26	23.1	41.9	35	16	8	4	BCTH-M1-P-6000ZZ	5	
	50			12	32	27.1	51.9	45		10	3	BCTH-M1-P-6201ZZ		
	28			6	19	16.1	29.9	22	17	6	5.5	BCTC-M1-P-626ZZ		
	38			10	26	23.1	39.9	32		8	5	BCTH-M1-P-6000ZZ		
	48						49.9	42						
	50	3.1	8				51.9	44	18					6
	60			12	32	27.1	61.9	54						
	75						76.9	69			4			
	100						101.9	94			10		BCTH-M1-P-6201ZZ	
	50			12	32	27.1	51.9	42				5.5		
	60	4.1	10				61.9	52	21					8
	100						101.9	92				5		
	60			15	35	30.1	61.9	50						
	100	5.1	12				101.9	90	25	11	7		BCTH-M1-P-6202ZZ	10
140						141.9	130							