

Order guide: C (Major category), FD (Series), Q (Category), C2 (Material), 65 (Specification)

Please refer to the series code to select the type and parameters for ordering

Code	Shape	Material ①	Surface treatment	Customization design
CFDQ-C2	Concentric	S45C	Blackening	A
CFDQ-S3		SUS303	—	

- ① If rust resistance is required, please give preference to stainless steel or electroless nickel-plated products.
- ② Features: Stainless steel products can be used in corrosion-resistant environments as well as in the cleaning of food machinery, ultrasonic, and other equipment.

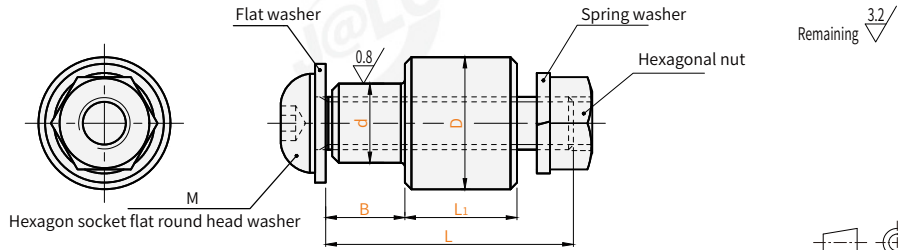

Visual standards: first perspective

Model Code	Specification ②	d _{g7}	B	L	L ₁	D	M	Spring washer	Flat washer		Nut
									S45C	SUS303	
CFDQ-C2 (S45C)	65	6	5.5	15	4	9.9	M4-L16	EPDB-J8D-B1-4	EPDA-C1D-B-4	EPDA-S1W-B-4	M4
	66		6	19	8.5		M4-L20				
	66A		11	24	4		M4-L25				
	611	8	7	19	5.5	11.9	M5-L20	EPDB-J8D-B1-5	EPDA-C1D-B-5	EPDA-S1W-B-5	M5
	87		24	12	M5-L25						
	87A		29	5.5	M5-L30						
	813	10	8	24	6.5	15.9	M6-L25	EPDB-J8D-B1-6	EPDA-C1D-B-6	EPDA-S1W-B-6	M6
	108		29	13.5	M6-L30						
	108A		34	6.5	M6-L35						
	1016	12	10	29	7.5	18.9	M8-L30	EPDB-J8D-B1-8	EPDA-C1D-B-8	EPDA-S1W-B-8	M8
	1210		39	15.5	M8-L40						
	1210A		16	7.5	M8-L40						
	1511	15	11	33	10	21.9	M10-L35	EPDB-J8D-B1-10	EPDA-C1D-B-10	EPDA-S1W-B-10	M10
	1511A		17	43	10		M10-L45				
	1517		12	12	12		M12-L45				
	1712	17	20	53	12	24.9	M12-L55	EPDB-J8D-B1-12	EPDA-C1D-B-12	EPDA-S1W-B-12	M12
1720	14		52	13	M16-L55						
2014	18		62	13	M16-L65						
2018	20	18	62	13	29.9	M16-L65	EPDB-J8D-B1-16	EPDA-C1D-B-16	EPDA-S1W-B-16	M16	
2521		21	62	13		M16-L65					
2521		25	21	62		13					M16-L65
CFDQ-S3 (SUS303)	87	8	7	19	5.5	11.9	M5-L20	EPDB-J8D-B1-5	EPDA-C1D-B-5	EPDA-S1W-B-5	M5
	87A		12	11.9	M5-L25						
	108	10	8	24	6.5	15.9	M6-L25	EPDB-J8D-B1-6	EPD-C1D-B-6A	EPDA-S1W-B-6	M6
	108A		29	13.5	M6-L30						
	1210	12	10	29	7.5	18.9	M8-L30	EPDB-J8D-B1-8	EPDA-C1D-B-8	EPDA-S1W-B-8	M8
	1210A		39	15.5	M8-L40						