

D FAH - 10

(Major category) (Series) (Category) 1 Specification

Please refer to the series code to select the type and parameters for ordering.

Code	Type	Type	Material	Heat treatment
DFAH	Clamping pin	Tapered	SUS630	Precipitation hardening

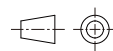
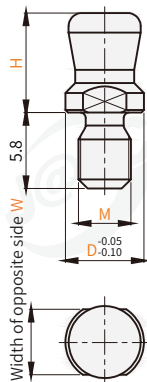

Depending on time and batch of surface treatment, there may be color differences between the actual product and the photo.

Perspective standard: first perspective

Model		D	M	H	W	Weight(g)	Applicable taper pin grasping type locker
Code	Specification 1						
DFAH	10	6	M4	7.6	5	2	DFAH-10
	14	8	M5	8.7	7	3	DFAH-14

General installation method

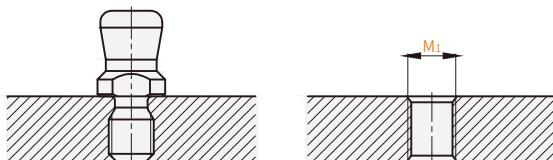

Installation method dimension table

Model		M ₁	d
Code	Specification 1		
DFAH	10	M4	7
	14	M5	9

Space-saving installation method

When the mounting surface of the clamping pin (tapered) is smaller than the mounting hole of the lock and is in contact with the bottom surface of the locker, it should be machined a countersink 0.5 ± 0.1 deep on the mounting surface.

Tapered pin grasping lock

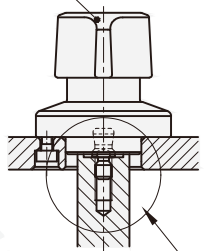

Enlarged view of A

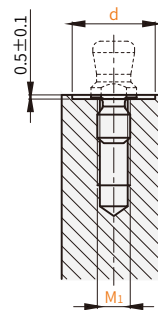
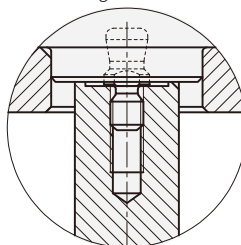

Self-locking button lock

