



E **KL** **H** - **D2** - **P3H** - **M3** - **L10**

Major category Series Block material Length

Order guide

Category Main ST Thread

Please refer to the series code to select the type and parameters for ordering.

Code	Appearance feature	Block shape	Thread	Main body			Block			Material	ST	Quantity	
				Material	ST 1	Strength Grade	Material 2	Hardness	Hardness				
EKLH-D2-P3H	Adjustable	Hexagonal head	Coarse teeth	SCM435	Glossy galvanized	10.9	Polyurethane	Shore A90	Black	SS400	Glossy galvanized	1PCS	
EKLH-D2-P3L				—	—	—	Shore A70	Blue	—	—	—	—	
EKLH-W-P3G				—	—	—	Lowresilience polyurethane	—	—	Grey	SUS304	—	1PCS
EKLH-W-P1H				—	—	—	—	—	—	Lowelasticity rubber	Shore A57	Black	—

- The block is adopted sintering process.
- It is suitable for supporting large workpieces.

EKLH-D2-P3H
EKLH-D2-P3L

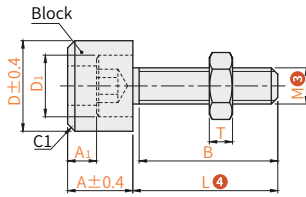

EKLH-W-P3G

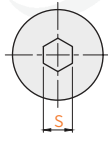

EKLH-W-P1H

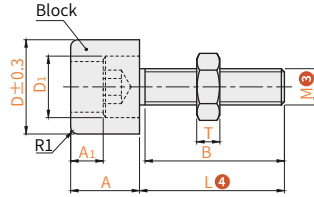

Perspective standard:
first perspective

Model	L 4										B	A	A1	D	D1	D2	S	T
	Code	M 6	EKLH-D2-P3H/EKLH-W-P3G					EKLH-D2-P3L										
EKLH-D2-P3H EKLH-D2-P3L EKLH-W-P3G	3	10 15	10 15					Full thread	6	—	—	7.5	5.5	3.3	2.5	2.4		
	4	10 15 20 25 30*	10 15 20 25 30*					Full thread(20)	7	3	—	10	7	4.2	3	3.2		
	5	10 15 20 25 30 40*	15 20 25 30 40*					Full thread(22)	9	—	—	12.5	8.5	5.5	4	4.5		
	6	10 15 20 25 30 40*50*	15 20 25 30 40*50*					Full thread(24)	10	—	—	15	10	6	5	5		
	8	10 15 20 25 30 40*50*60*	25 30 40*50*60*					Full thread(28)	13	5	—	20	13	7.3	6	6.5		
	10	10 15 20 25 30 40 50*60*70*	30 40 50*60*70*					Full thread(32)	15	—	—	25	16	10	8	8		
	12	15 20 25 30 40	—					Full thread	18	—	—	30	18	13	10	10		
	16	20 25 30 40	—					Full thread	22	6	—	40	24	17	14	14.5		

The L1 values with *L dimensions are (*) inside dimensions, not full threads.

Model	L 4										B	A	A1	D	D1	D2	S	T	Impact absorption (kgf-cm)	Load resistance (kgf)
	Code	M 6	EKLH-W-P1H																	
EKLH-W-P1H	4	10 15 20 25 30*	Full thread(20)					8.2	4.2	11	7	5	3	3.2	0.055	2.4				
	5	15 20	Full thread					9.5	4.5	13	8.5	7	4	4	0.072	3				
	6	15 20 25 30 40*	Full thread(24)					11	5	18	10	8	5	5	0.197	7.4				
	8	25 30	Full thread					13.7	5.7	20	13	9	6	6.5	0.272	8.8				
	1	40 50*	Full thread(32)					15.6	5.6	25	16	12	8	8	0.444	14.4				

The *L1 values with L dimensions are () inside dimensions, not full threads.

Screw with block