

E Major category | MJ Series | B Category | A10 Body material | - d3 Diameter | - L4 Length

Order guide: **1** Body material | **2** Diameter | **3** Length

Please refer to the series code to select the type and parameters for ordering.

Model	Body material ①		ST	Shape	Strength rating	Standard No.
	Rivet body	Rivet stem				
EMJB-A10	A5050	1008	—	Cotter type	08	GB/T 12617.1-2006
EMJB-S1	SUS304			countersunk head	A2-70	GB/T 12617.4-2006

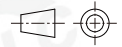
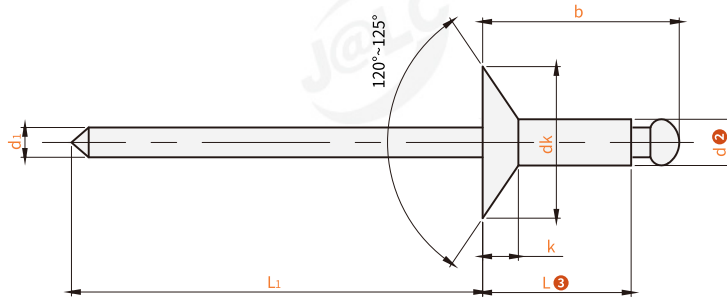

Perspective standard: first perspective

Model		L③	d1	b	dk	Hole diameter	Riveting range		K max	L1	Min. tensile load (N)	Min. shear load (N)
Code	d②						Min	Max				
EMJB-A10	3	6					1	3.2				
		7					1	3.5				
		8					2	4.2				
		9					3	5.2				
		10	2	L+3.5	5.4~6.3	3.1~3.2	4	6.2	1.3	25	550	400
		11					5	7.2				
		12					6	8.2				
		13					7	9.2				
		14					8	10.2				
		16					10	12.2				
		6					2.0	3.5				
		7					1	3.2				
		8					2	4.2				
		9					3	5.2				
		10					4	6.2				
		11	2	L+4	5.8~6.7	3.3~3.4	5	7.2	1.3	25	700	500
	12					6	8.2					
	13					7	9.2					
	14					8	10.2					
	16					10	12.2					
	19					13	15.2					
	6					1	3					
	7					1	3					
	89					1.5	3.5					
						2	4.5					
	10					3	5.5					
	11					4	6.6					
	12	2.45	L+4	6.9~8.4	4.1~4.2	5	7.6	1.7	25	1200	850	
	13					6	8.6					
	14					7	9.6					
	16					9	11.6					
	18					11	13.6					
	20					13	15.6					
	22					14	16					
	25					16	21					
	6					1	2.5					
8					2.5	4						
10					4	6						
12					6	8						
14	2.95	L+4.5	8.3~10.1	4.9~5.0	8	10	2	27	1700	1200		
16					8	12						
18					10	14						
20					12	15						
25					20	25						

Rivet

Model		L ^③	d ₁	b	dk	Hole diameter	Riveting range		K _{max}	L ₁	Min. tensile load (N)	Min. shear load (N)
Code	d ^②						Min	Max				
EMJB-A10	5	8	2.95	L+4.5	8.7~10.5	5.1~5.2	1	3.5	2.1	27	2000	1400
		9					1	3.7				
		10					2	4.7				
		11					3	5.7				
		12					4	6.7				
		13					5	7.7				
		14					6	8.7				
		16					8	10.7				
		18					10	12.7				
		20					12	14.7				
		25					14	16				

Model		L ^③	d ₁	b	dk	Hole diameter	Riveting range		K _{max}	L ₁	Min. tensile load (N)	Min. shear load (N)	
Code	d ^②						Min	Max					
EMJB-S1	3	6	2.05	L+4	5.4~6.3	3.1~3.2	0.5	1.5	1.3	25	2200	1800	
		7					1	3.2					
		8					2	4.2					
		9					3	5.2					
		10					4	6.2					
		11					5	7.2					
		12					6	8.2					
		13					7	9.2					
		14					8	10.2					
		16					10	12.2					
		19					13	15.2					
	3.2	2.15	L+4	5.8~6.7	3.3~3.4	3.3~3.4	6	8.2	1.3	25	2500	1900	
							7	1					3.2
							8	2					4.2
							9	3					5.2
							10	4					6.2
							11	5					7.2
							12	6					8.2
							13	7					9.2
							14	8					10.2
							16	10					12.2
							19	13					15.2
	4	2.75	L+4.5	6.9~8.4	4.1~4.2	4.1~4.2	2	3.0	1.7	27	3500	2700	
							8	1					3.5
							9	2					4.5
							10	3					5.5
							11	4					6.6
							12	5					7.6
							13	6					8.6
							14	7					9.6
							16	9					11.6
							18	11					13.6
							20	13					15.6
	4.8	3.2	L+5	6.9~8.4	4.9~5.0	4.9~5.0	8	2.5	2	27	5000	4000	
							9	3					5
							10	4					6
							11	5					7
							12	6					8
							13	6.5					9
							14	7					9.5
							16	8					11
							17	9					12
							18	11					13
							20	13					15
	25	15	19										
5	3.25	L+5	8.3~10.1	5.1~5.2	5.1~5.2	8	1	2.1	27	5800	4700		
						9	1					3.7	
						10	2					4.7	
						11	3					5.7	
						12	4					6.7	
						13	5					7.7	
						14	6					8.7	
						16	8					10.7	
						17	9					11.7	
						18	10					12.7	
						20	12					14.7	
25	14	16											

Rivet