

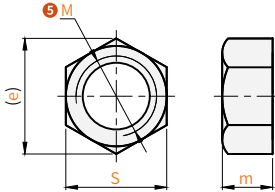

Please refer to the series code to select the type and parameters for ordering.

| Code | Type ③ | Screw teeth ④ | Material ① | Strength Grade | ST ② | Applicable standard |
|---------------|-----------|---------------|------------|----------------|------------|---------------------|
| EMLA-C2E1-BL1 | Standard | Coarse teeth | S45C | 8 | Blackened | DIN 934-1987 |
| EMLA-C2D-BL1 | | | | 4 | Galvanized | |
| EMLA-S1W-BL1 | | | SUS304 | — | — | |
| EMLA-S2W-BL1 | | Fine teeth | S45C | A4-70 | — | GB/T 6171-2000 |
| EMLA-C2E1-BL2 | | | | — | Blackened | |
| EMLA-C2D-BL2 | | | | — | Galvanized | |
| EMLA-S1W-BL2 | Thin | Coarse teeth | SUS304 | — | — | GB/T 6172.1-2000 |
| EMLA-S1W-B1L1 | Thickened | | SUS304 | 8 | — | — |
| EMLA-C2D-B2L1 | | | S45C | — | Galvanized | GB/T 6175-2016 |
| EMLA-S1-B2L1 | | | SUS304 | — | — | |

Standard type
EMLA-C2E1-BL1/EMLA-C2D-BL1
EMLA-S1W-BL1/EMLA-S2W-BL1
EMLA-C2E1-BL2/EMLA-C2D-BL2/
EMLA-S1W-BL2



Applicable standards for this product:
DIN 934-1987

Thin type
EMLA-S1W-B1L1

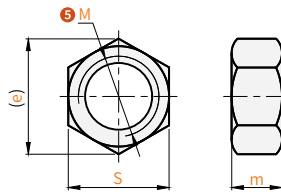

Applicable standards for this product:
GB/T 6172.1-2000
ISO 4035-2001
DIN 439-2-1987
JIS B 1181-2004

Thickened type
EMLA-C2D-B2L1
EMLA-S1-B2L1

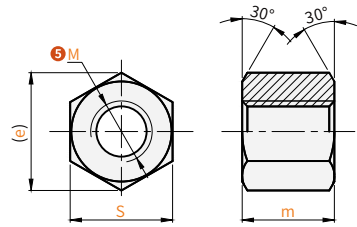

Applicable standards for this product:
GB/T 6175-2016
ISO 4033-2001
JIS B 1181-2004



Standard type

| Code | Model | | P Pitch | m | S | e |
|---|-------|--|---------|-----|-----|------|
| | M ⑤ | | | | | |
| Coarse teeth EMLA-C2E1-BL1 EMLA-C2D-BL1 EMLA-S1W-BL1 | 2 | | 0.4 | 1.6 | 4 | 4.6 |
| | 2.5 | | 0.45 | 2 | 5 | 5.8 |
| | 3 | | 0.5 | 2.4 | 5.5 | 6.4 |
| | 4 | | 0.7 | 3.2 | 7 | 8.1 |
| | 5 | | 0.8 | 4 | 8 | 9.2 |
| | 6 | | 1.0 | 5 | 10 | 11.5 |
| | 8 | | 1.25 | 6.5 | 13 | 15.0 |
| | 10 | | 1.5 | 8 | 17 | 19.6 |
| | 12 | | 1.75 | 10 | 19 | 21.9 |
| | 16 | | 2.0 | 13 | 24 | 27.7 |
| | 20 | | 2.5 | 16 | 30 | 34.6 |
| | 24 | | 3.0 | 19 | 36 | 41.6 |

Standard type

| Code | Model | | P Pitch | m | S | e |
|--------------|-------|--|---------|-----|-----|------|
| | M ⑤ | | | | | |
| EMLA-S2W-BL1 | 3 | | 0.5 | 2.4 | 5.5 | 6.4 |
| | 4 | | 0.7 | 3.2 | 7 | 8.1 |
| | 5 | | 0.8 | 4 | 8 | 9.2 |
| | 6 | | 1 | 5 | 10 | 11.5 |
| | 8 | | 1.25 | 6.5 | 13 | 15 |
| | 10 | | 1.5 | 8 | 17 | 19.6 |
| | 12 | | 1.75 | 10 | 19 | 21.9 |
| | 16 | | 2.0 | 13 | 24 | 27.7 |
| | 20 | | 2.5 | 16 | 30 | 34.6 |
| | 24 | | 3.0 | 19 | 36 | 41.6 |

Standard type

| Code | Model | | P Pitch | m | S | e | |
|-----------------------------|----------------------------|----|---------|------|------|-------|-------|
| | M ⑤ | | | | | | |
| Fine teeth EMLA-C2E1-BL2 | 8 | | 1.0 | 6.8 | 13 | 14.38 | |
| | 10 | | 1.0 | 8.4 | 16 | 17.77 | |
| | 12 | | 1.25 | 10.8 | 18 | 20.03 | |
| | 14 | | | 12.8 | 21 | 23.36 | |
| | 16 | | | 14.8 | 24 | 26.75 | |
| | 18 | | 1.5 | 15.8 | 27 | 29.56 | |
| | 20 | | | 18 | 30 | 32.95 | |
| | 22 | | | 19.4 | 34 | 37.29 | |
| | 24 | | 2.0 | 21.5 | 36 | 39.55 | |
| | Fine teeth EMLA-C2D-BL2 | 10 | | 1.0 | 8.4 | 16 | 17.77 |
| | | 12 | | 1.25 | 10.8 | 18 | 20.03 |
| | | 14 | | | 12.8 | 21 | 23.36 |
| 16 | | | 1.5 | 14.8 | 24 | 26.75 | |
| Fine teeth EMLA-S1W-BL2 | 10 | | 1.0 | 8.4 | 16 | 17.77 | |
| | 12 | | 1.25 | 10.8 | 18 | 20.03 | |
| | 14 | | | 12.8 | 21 | 23.36 | |
| | 16 | | 1.5 | 14.8 | 24 | 26.75 | |
| | 20 | | | 18 | 30 | 32.95 | |

Thin type

| Code | Model | | P Pitch | m | S | e |
|-------------------------------|-------|--|---------|-----|-----|-------|
| | M ⑤ | | | | | |
| Coarse teeth EMLA-S1W-B1L1 | 2 | | 0.4 | 1.2 | 4 | 4.42 |
| | 2.5 | | 0.45 | 1.6 | 5 | 5.58 |
| | 3 | | 0.5 | 1.8 | 5.5 | 6.1 |
| | 4 | | 0.7 | 2.2 | 7 | 7.66 |
| | 5 | | 0.8 | 2.7 | 8 | 8.79 |
| | 6 | | 1.0 | 3.2 | 10 | 11.05 |
| | 8 | | 1.25 | 4 | 13 | 14.38 |
| | 10 | | 1.5 | 5 | 17 | 18.9 |
| | 12 | | 1.75 | 6 | 19 | 21.1 |
| | 14 | | 2.0 | 7 | 22 | 24.38 |
| | 16 | | 2.0 | 8 | 24 | 26.75 |
| | 20 | | 2.5 | 10 | 30 | 33.53 |

Thickened type

| Code | Model | | P Pitch | m | S | e |
|---|-------|--|---------|------|----|-------|
| | M ⑤ | | | | | |
| Coarse teeth EMLA-C2D-B2L1 EMLA-S1-B2L1 | 6* | | 1.0 | 5.7 | 10 | 11.05 |
| | 8 | | 1.25 | 7.5 | 13 | 14.38 |
| | 10 | | 1.5 | 9.3 | 16 | 17.77 |
| | 12 | | 1.75 | 12.0 | 18 | 20.03 |
| | 16 | | 2.0 | 16.4 | 24 | 26.75 |
| | 20 | | 2.5 | 20.3 | 30 | 32.95 |
| | 24 | | 3.0 | 23.9 | 36 | 39.55 |

Specifications with * are only available for the EMLA-S1-B2L1.

Screw nut