

**E SL J - S1 - W - M6 - L60**

Major category (E) Series (SL) Surface treatment (J) Length (S1) Material (W) Nominal size (M6) Length (L60)

Order guide: (E) Major category, (SL) Category, (J) Material, (S1) Nominal size, (W) Surface treatment, (M6) Nominal size, (L60) Length

Please refer to the series code to select the type and parameters for ordering.

**E SL K - M6 - L12**

Major category (E) Series (SL) Length (K) Nominal size (M6) Length (L12)

Order guide: (E) Major category, (SL) Category, (K) Length, (M6) Nominal size, (L12) Length

Please refer to the series code to select the type and parameters for ordering.

Expansion Bolt Wedge Anchor

Code	Thread length	Thread	Material	Surface treatment
ESLJ-CD	Half thread	Coarse thread	Carbon steel	Galvanized
ESLJ-S1W	Half thread	Coarse thread	SUS304	No

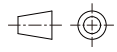
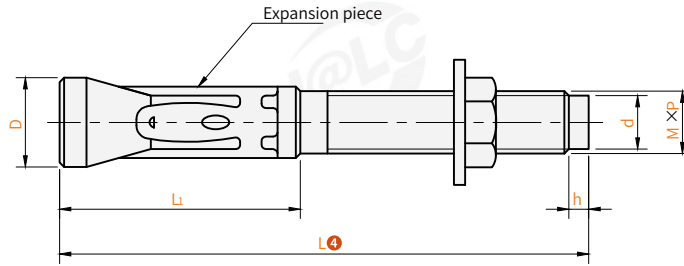

Visual standards:  
first perspective

Model		L <sup>4</sup>					Pitch P	D	L <sub>1</sub>	d	h			
Code	M <sup>3</sup>													
Carbon steel ESLJ-CD	6	60	70	80	90	100	1	6	27	4.5	2.5			
	8	60	70	75	80	90	95	100	120	1.25		8	32	6
SUS304 ESLJ-S1W	10	60	70	75	80	90	100			1.5	10	35	7.5	4
	12			80	90	100	110	120	140	1.75	12	42	9.5	
	16					100	120	140		2	16	52	13	

Expansion bolt Foundation bolt

Code	Thread length	Thread	Material	Surface treatment	Standard No.
ESLK	Half thread	Coarse thread	SUS304	No	GB/T 29.2-1988

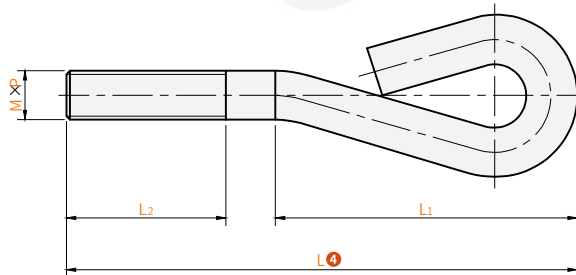

Visual standards:  
first perspective

Model		L <sup>4</sup>		Pitch P	L <sub>1</sub>	L <sub>2</sub>
Code	M <sup>3</sup>					
ESLK	20	300 400		2.5	127	58
	24			3	139	68

Bolt