

F TC R - U1 - d4 - L5
 Major category Series Diameter
 Order guide Category 1 Shoulder shape 3 Length

Please refer to the series code to select the type and parameters for ordering.

Press-in type

Code	Shoulder shape ①	Type	Size selection	d Tolerance	P Tolerance	Material	ST	Hardness
FTCR-U1	Shoulderless	Press-in	L size specified	F7	m7	SUJ2	—	56HRC~
FTCR-U	Shouldered							

Shoulderless type
FTCR-U1

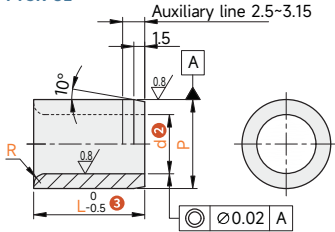

Shouldered type
FTCR-U

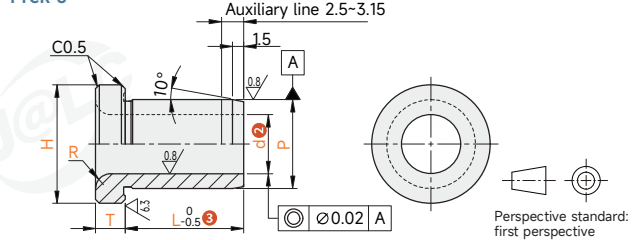

Shoulderless type

Code	Model	dF7 ②	L ③								Pm7	R
FTCR-U1	4	+0.022 +0.010	5	6	8					8	+0.021 +0.006	1
	5		6	8	10					10		
	6	+0.028 +0.015	5	6	8	10	12	15	16	20	+0.025 +0.007	2
	8		6	8	10	12	15	16	20	25		
	10		8	10	12	15	16	20	25			
	12		10	12	15	16	20	25	30	18		

With shoulder type

Code	Model	dF7 ②	L ③					Pm7	H	T	R	
FTCR-U	4	+0.022 +0.010	5	6			8	+0.021 +0.006	12	3	1	
	5		6				10					
	6	+0.028 +0.015	5	6	8	10	12	15	+0.025 +0.007	16	4	2
	8		6	8	10	12	15					
	10		6	8	10	12						
	12		8	10	12							

Adhesive type

Code	Shoulder shape ①	Type	Size selection	d Tolerance	P Tolerance	Material	ST	Hardness
FTCS-U1	Shoulderless	Adhesive type	L size specified	H7	g7	SUJ2	—	56HRC~
FTCS-U	Shouldered							

Installation notes

- The outer diameter of the bushing is negative tolerance, and the ideal position of the bushing in the mounting hole is determined by fine-tuning the clearance with the mounting hole, and finally by using the positioning pin as the positioning reference.
- 1-3 grooves are machined at the outer diameter of the bushing, and the installation of the bushing is fixed by applying glue to realize the effect of fine-tuning the installation position of the bushing and effectively ensuring the positioning accuracy.
- Number of grooves at outer diameter: 1 groove when L<L/2; 2 grooves when 10<L<12, V=L/3; 3 grooves when L>12, V=L/4.

Shoulderless type
FTCS-U1

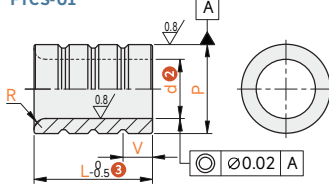

With shoulder type C0.5
FTCS-U

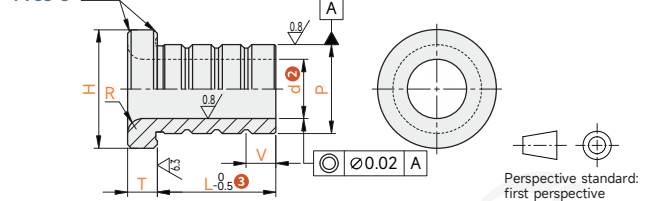

Shoulderless type

Code	Model	dH7 ②	L ③								Pg7	R
FTCS-U1	4	+0.022 0	5	6	8					8	+0.025 +0.020	1
	5		6	8	10					10		
	6	+0.015 0	5	6	8	10	12	15	16	20	+0.006 +0.024	2
	8		6	8	10	12	15	16	20	25		
	10		8	10	12	15	16	20	25			
	12		10	12	15	16	20	25	30	18		

With shoulder type

Code	Model	dH7 ②	L ③					Pm7	H	T	R	
FTCS-U	4	+0.012 0	5	6			8	+0.025 +0.020	12	3	1	
	5		6				10					
	6	+0.015 0	5	6	8	10	12	15	+0.006 +0.024	16	4	2
	8		6	8	10	12	15					
	10		6	8	10	12						
	12		8	10	12							