

**F** **TD** **D** - **M2** - **W** - **B** - **D7** - **d2** - **L5**  
 Major category Series 2 ST 4 Tolerance class 6 Length  
 Order guide Category 1 Material 3 Wall thickness 5 Diameter  
 Please refer to the series code to select the type and parameters for ordering.

Wall thickness 3		Shoulder shape	Size selection	Tolerance class 4	Material 1	ST 2	Hardness	
Standard type	Thin-wall							
FTDD-M2W-BD7	FTDD-M2W-B1D7	Shoulderless	L size selection	Pp6	SKS3	—	58HRC~	
FTDD-M2N1-BD7	FTDD-M2N1-B1D7							Electroless nickel plating
FTDD-S6W-BD7	FTDD-S6W-B1D7			Pm6	SUS440C	SKS3	—	48-53HRC
FTDD-M2W-BD8	FTDD-M2W-B1D8							
FTDD-M2N1-BD8	FTDD-M2N1-B1D8					58HRC~		
FTDD-S6W-BD8	FTDD-S6W-B1D8					—	48-53HRC	

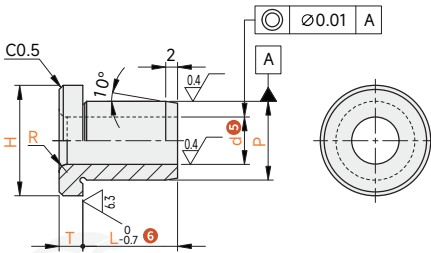

Standard type  
FTDD-M2W/M2N1/S6W-BD7/BD8



Thin-wall type  
FTDD-M2W/M2N1/S6W-B1D7/B1D8

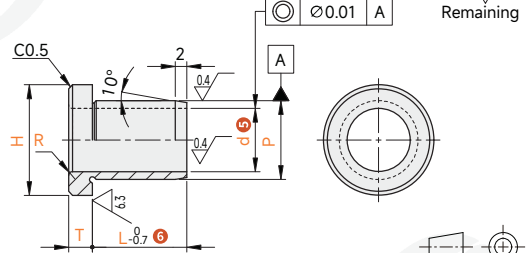

Standard type

Model		d Tolerance		L 6				R	H	T	P	P Tolerance							
Code	d 5	No surface treatment	Electroless nickel plating									p6	6						
Pp6 FTDD-M2W-BD7 FTDD-M2N1-BD7 FTDD-S6W-BD7	2	+0.008		+0.010	5	6	8	10	12	0.8	9	2.5	5	+0.020	+0.012				
	3	+0.002		0	5	6	8	10	12					7				+0.012	+0.004
	4			H7		5	6	8	10	12	15	16	20	12	8	+0.024	+0.015		
	5	+0.012		+0.012		5	6	8	10	12	15	16	20	25	10	+0.015	+0.006		
	6					5	6	8	10	12	15	16	20	25					
	8	G6	+0.014		+0.014	5	6	8	10	12	15	16	20	25					
Pm6 FTDD-M2W-BD8 FTDD-M2N1-BD8 FTDD-S6W-BD8	10	+0.014		+0.014	6	8	10	12	15	16	20	25	30	16	12	+0.029	+0.018		
	12				8	10	12	15	16	20	25	30		19	4	15	+0.018	+0.007	
	13													2.0	22	18			
	15	+0.017		+0.017											26	22			
	16	+0.006		+0.006											30	5	25	+0.035	+0.021
	20															26	26	+0.022	+0.008
	25	+0.020		+0.020		10	12	15	16	20	25	30		3.0	35	6	30	+0.042	+0.025
		+0.007		+0.007													35	+0.026	+0.009

Thin-wall type

Model		d Tolerance		L 6				R	H	T	P	P Tolerance						
Code	d 5	No surface treatment	Electroless nickel plating									p6	6					
Pp6 FTDD-M2W-B1D7 FTDD-M2N1-B1D7 FTDD-S6W-B1D7	3	+0.008		+0.010	6	8	10	12		0.5	9	2.5	5	+0.020	+0.012			
	4	+0.002		0	6	8	10	12	15					16	7			
	5			H7		6	8	10	12	15	16	20	10	3	6	+0.024	+0.015	
	6	+0.012		+0.012		6	8	10	12	15	16	20		11	7	+0.015	+0.006	
	8					6	8	10	12	15	16	20		12	8			
	10	G6	+0.014		+0.014	6	8	10	12	15	16	20		14	10	+0.029	+0.018	
Pm6 FTDD-M2W-B1D8 FTDD-M2N1-B1D8 FTDD-S6W-B1D8	12	+0.014		+0.014	6	8	10	12	15	16	20		17	4	13	+0.018	+0.007	
	13				8	10	12	15	16	20			19	15				
	15	+0.017		+0.017									1.0	21	17			
	16	+0.006		+0.006										24	5	19	+0.035	+0.021
	20													26	21	26	+0.022	+0.008
	25	+0.020		+0.020		10	12	15	16	20	25		2.0	31	6	26	+0.042	+0.025
		+0.007		+0.007												31	+0.026	+0.009

Bushings for Fixture & Positioning Pin