

**H** **GY** **G - Y - 0808** - **M3** - **L6**  
 Major category    Series    Shape    Specification    Thread specification    Screw length  
 Order guide    Category    Shape    Specification    Thread specification    Screw length  
 Please refer to the series code to select the type and parameters for ordering.

Code	Mounting type	Shape 1	Material		Rubber hardness	Surface treatment
			Rubber body	Metal parts		
HGYG-Z	One end male thread and one end female thread	Cylindrical	Natural rubber	S45C	Shore A60°	Galvanized
HGYG-Y		Waist				

- Due to the production process, a small amount of rubber/bonding agent residue may be caused, which does not affect the product performance.
- As the product contains anti-aging additives, the surface of the product will continue to slowly precipitate white wax, which is a normal phenomenon and does not affect the product's performance.

Cylindrical  
HGYG-Z

Waist  
HGYG-Y

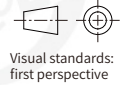
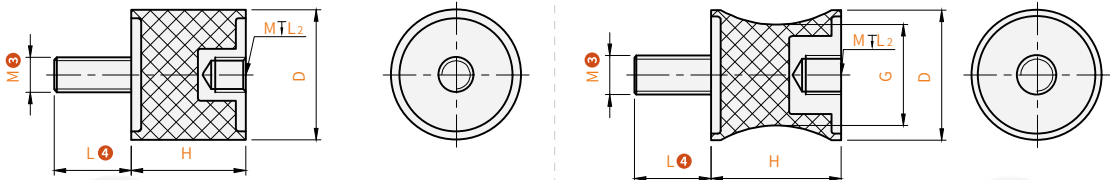

○ Cylindrical

Model		M 3	L 4	D	H	Lz(min)	Optimal load (KG)	Optimal compression (mm)	
Code	Specification 2								
HGYG-Z	0808	3	6	8	8	3	8	1.5	
	1010			10	10		10		
	1510								
	1515	4	10	15	15	4	18		
	1520				20				
	2015			20	15		25	2.0	
	2020								
	2520	6	18	25	20	6	33		
	2525				25				
	3020				20				
	3025					25		40	
	3030			20	30				
	3040					30		50	2.5
	4020	8			20	40	8	48	2.0
	4030			23	40	30		60	2.5
	4040					40		72	3.0
	5020					20		56	2.0
	5030					30		70	2.5
	5040	10	25	50	40	10		85	3.0
	5050					50			
6030			30	60	30		110	2.5	
6040	12	37			40	12			
6060					60		132	3.0	

○ Waist

Model		M 3	L 4	D	H	G	L2	Optimal load (KG)	Optimal compression (mm)
Code	Specification 2								
HGYG-Y	2020			20		14.5		15	
	2520	6	18	25	20	17	7	20	2.0
	3020		20	30		24	8	33	
	4030	8	23	40	30	20	9	23	
	6060	10	25	60	60	50	10	85	3.0